

UNIVERSAL E- KIT EXPERT

737350

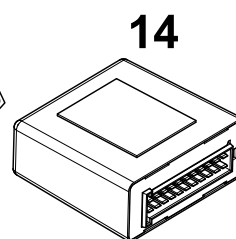

1

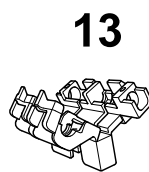
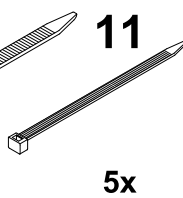
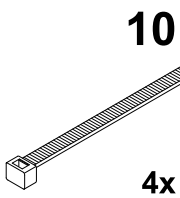
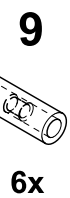
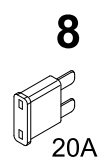
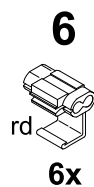
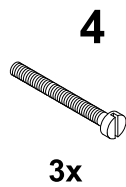
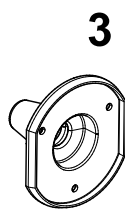
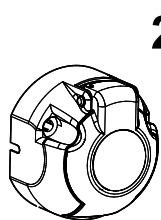
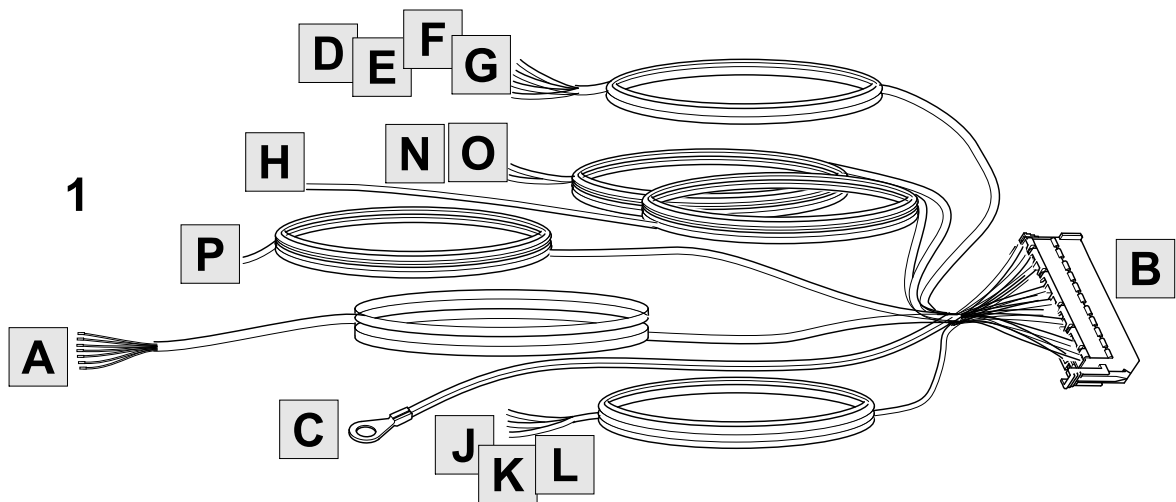
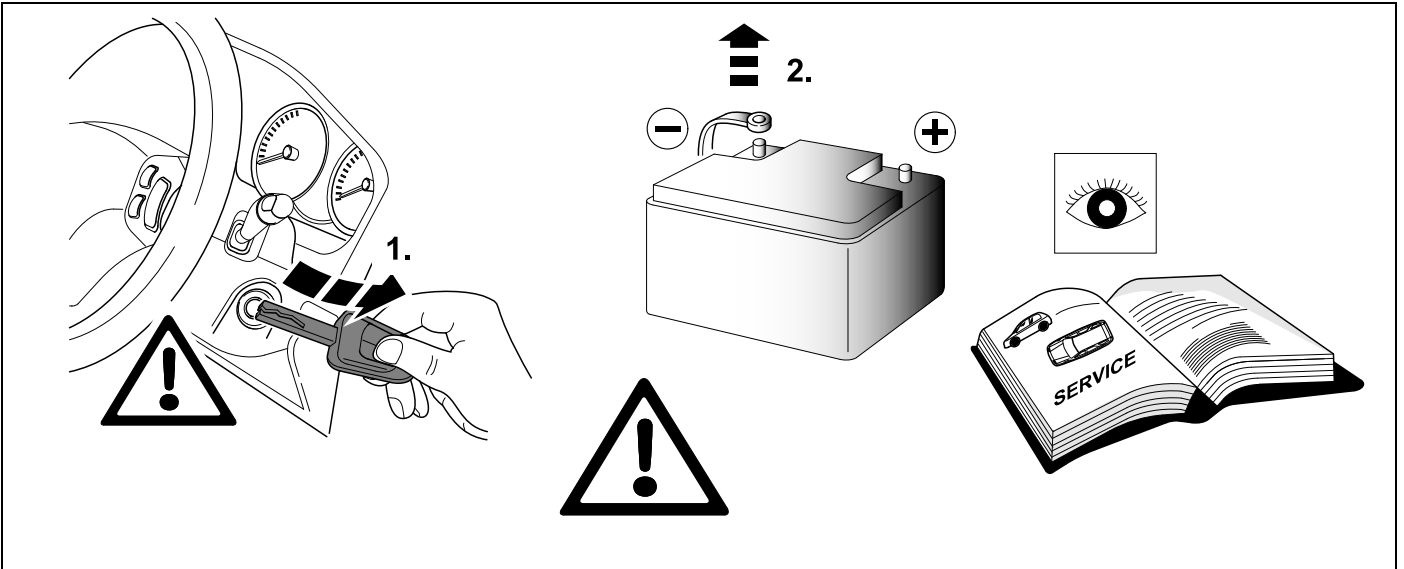

2

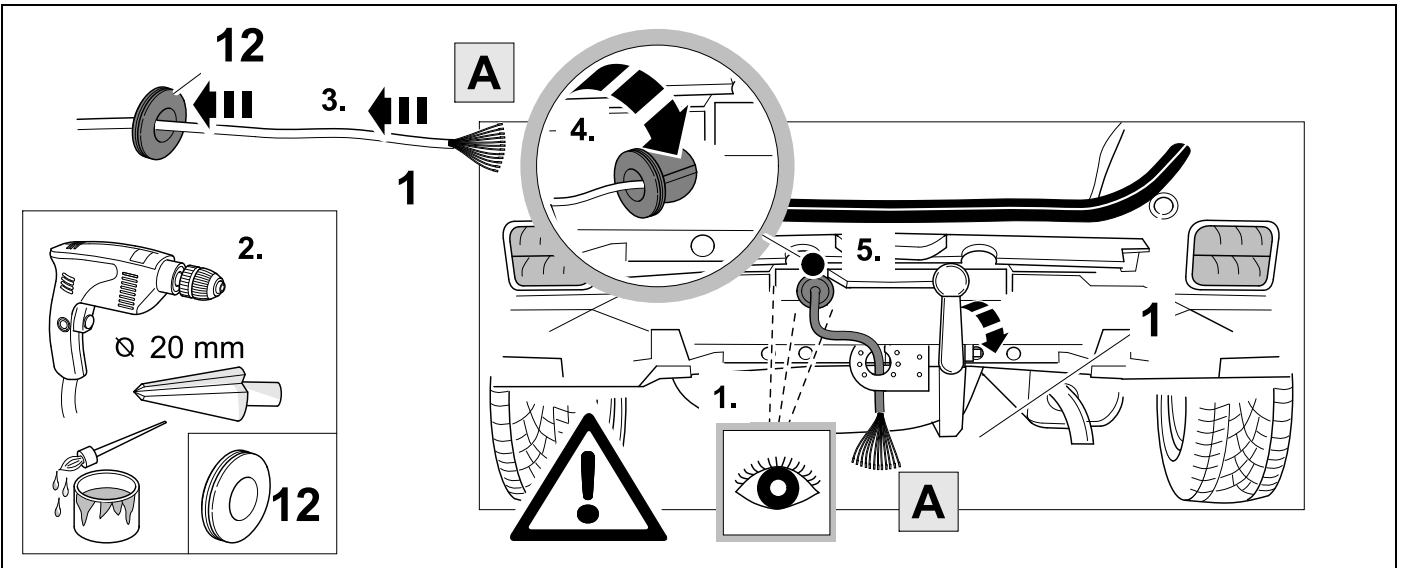

3



4

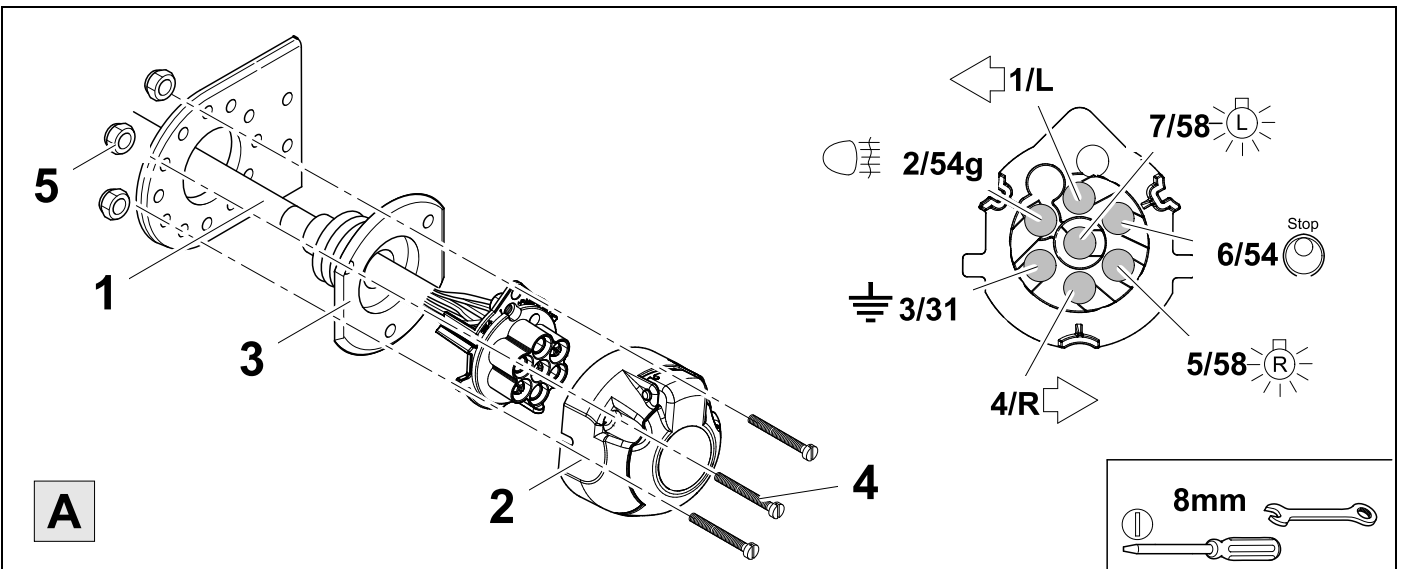

4



5

1/L	ye	
2/54g	bu	
3/31	wh	
4/R	gn	
5/58R	bn	
6/54	rd	
7/58L	bk	

5	bk	wh	gy	gn	rd	bu	ye	bn	pu	og
(D)	schwarz	weiß	grau	grün	rot	blau	gelb	braun	violett	orange
(GB)	black	white	grey	green	red	blue	yellow	brown	purple	orange
(F)	noir	blanc	gris	vert	rouge	bleu	jaune	brun	violet	orange
(NL)	zwart	wit	grijs	groen	rood	blauw	geel	bruin	violet	oranje
(DK)	sort	hvid	grå	grøn	rød	blå	gul	brun	violet	orange
(N)	svart	hvit	grå	grønn	rød	blå	gul	brun	fiolett	oransje
(S)	svart	vit	grå	grön	röd	blå	gul	brun	violett	orange
(FIN)	musta	valkoinen	harmaa	vihreä	punainen	sininen	keltainen	ruskea	violetti	oranssi
(I)	nero	bianco	grigio	verde	rosso	blu	giallo	marrone	viola	arancione
(E)	negro	blanco	gris	verde	rojo	azul	amarillo	marrón	violeta	anaranjado
(P)	preto	branco	cinzento	verde	vermelho	azul	amarelo	castanho	violeta	laranja
(GR)	μαύρος	λευκός	Γκρι	πράσινος	κόκκινος	μπλε	κίτρινος	καφέ	Μωβ	πορτοκαλί
(PL)	czarny	biały	szary	zielony	czerwony	niebiesko	żółty	brazowy	fioletowy	pomarańczowy
(CZ)	černý	bílý	šedý	zelený	červený	modrý	žlutý	hnědý	fialový	oranžový
(TR)	siyah	beyaz	gri	yeşil	kırmızı	mavi	sarı	kahverengi	mor	portakal rengi
(H)	fekete	fehér	szürke	zöld	piros	kék	sárga	barna	ibolyakék	narancssárga
(HR)	crno	bijelo	sivo	zeleno	crveno	plavo	zuto	smeđe	ljubičasto	narandasto
(BUL)	черен	бял	сив	зелен	червен	син	жълт	кафяв	виолетов	оранжев
(RO)	negru	alb	gri	verde	roșu	albastru	galben	maro	violet	portocaliu
(RU)	черный	белый	серый	зеленый	красный	голубой	желтый	коричневый	пурпур-ный	оранжевый
(LT)	juoda	balta	pilka	žalia	raudona	mėlyna	geltona	ruda	purpurinė	oranžinė
(LV)	melna	balta	pelēka	zaļa	sarkana	zila	dzeltena	brūna	purpur-sarkana	oranža
(EST)	must	valge	hall	roheline	punane	sinine	kollane	pruun	purpur-punane	oraanž
(SLO)	črna	bela	siva	zelena	rdeča	modra	rumena	smeđ	vijoličast	oranžen
(SK)	čierny	biely	šedý	zelený	červený	modrý	žltý	hnedý	fialový	pomarančový

6

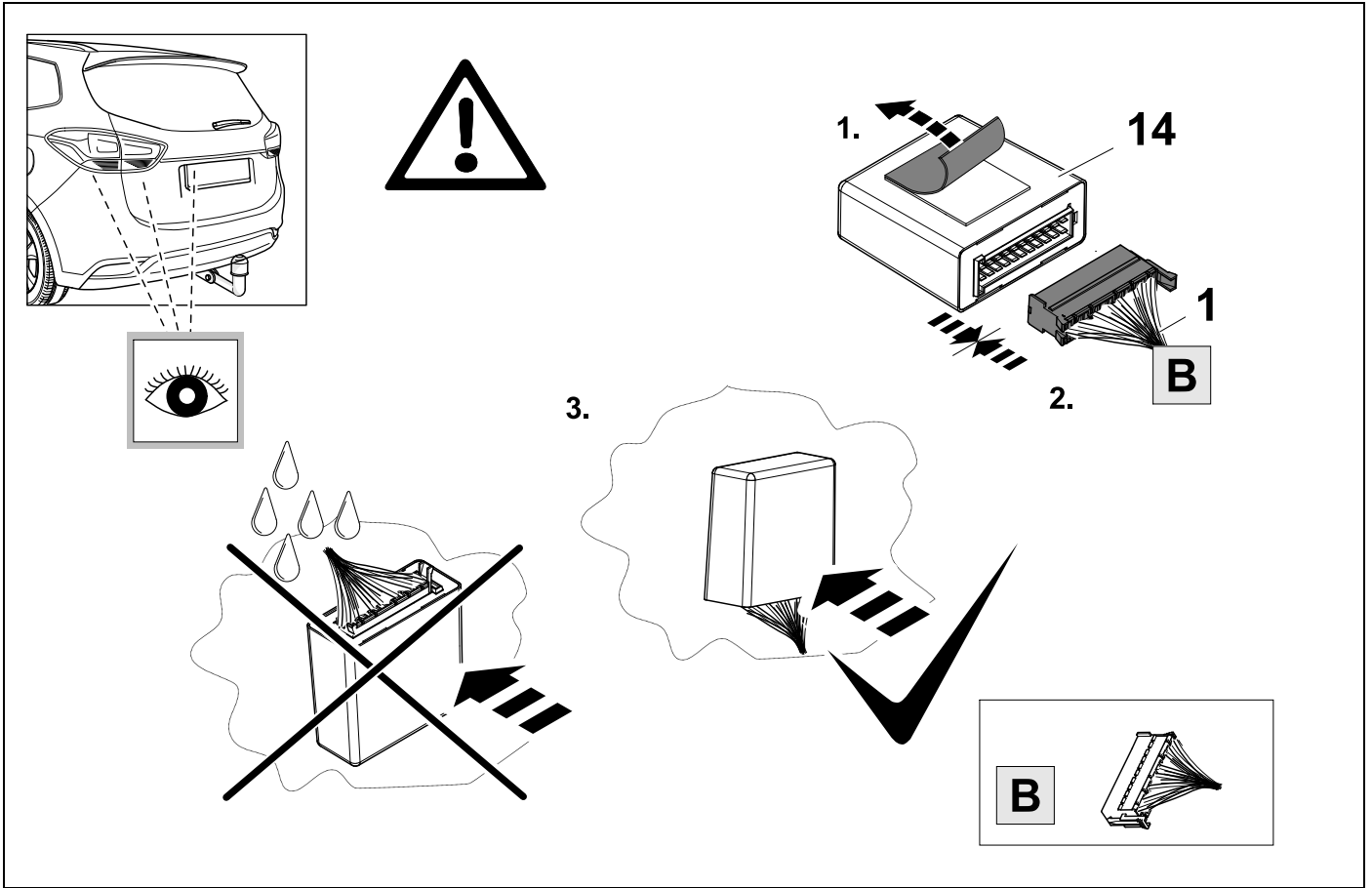

7

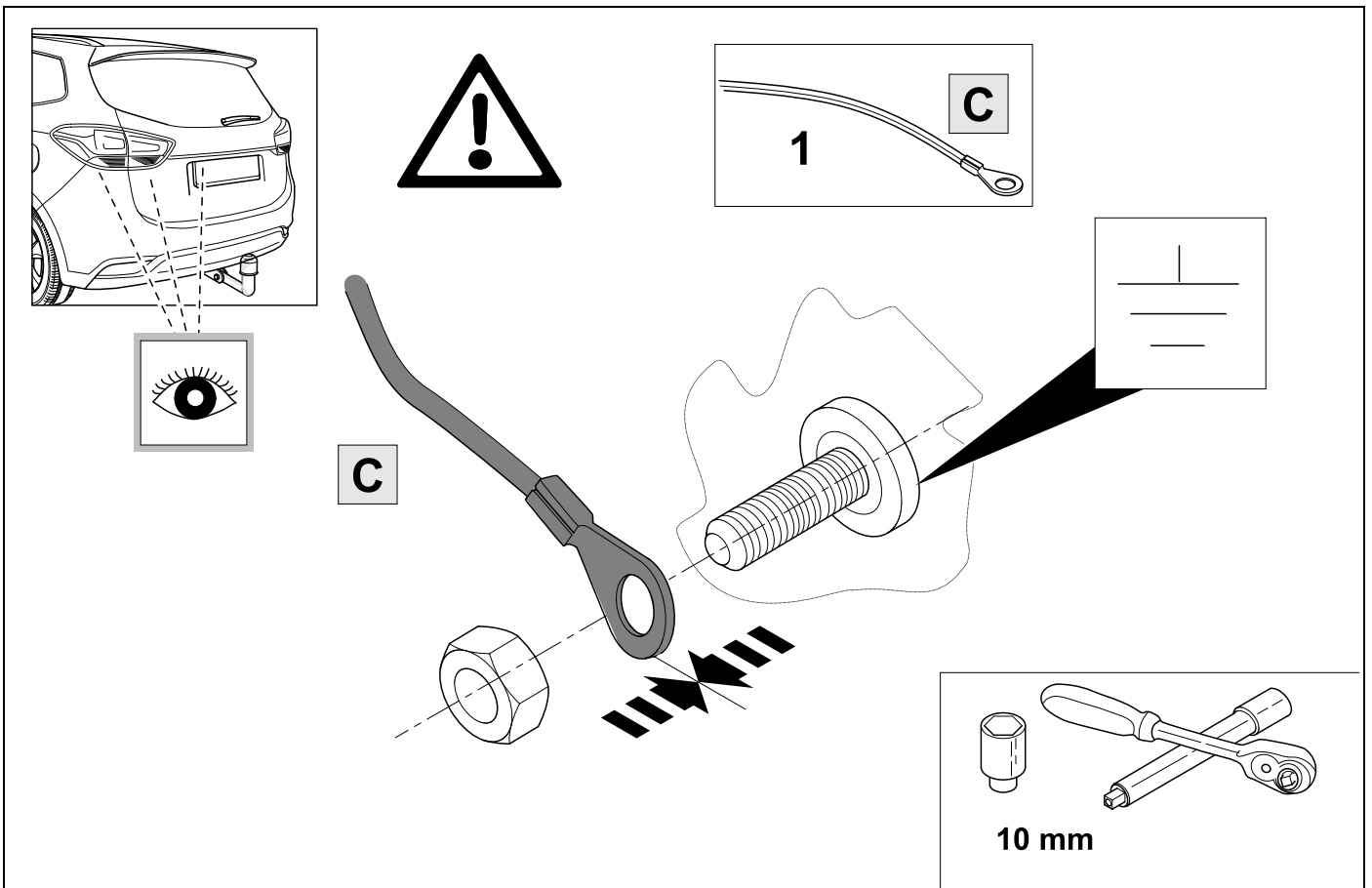

8 WITHOUT TRAILER FLASHER CONTROL OPTION 1A

Timing diagram showing three channels (1, 2, 3) and a vehicle diagram with a trailer. Channel 1 is active during left turn, channel 2 during right turn, and channel 3 during braking. A warning triangle is shown below the diagram.

~~D A GB~~

BUL CH CZ DK E EST F FIN
 H HR I LT LV N NL GR ✓
 RO RU S SK SLO TR P PL

9



5

OPTION 1A

Diagram showing the correct wiring configuration for Option 1A. The car's turn signal system (L and R) is connected to the trailer light (D and E). A warning triangle is shown in the center. The diagram is divided into two parts: the top part shows the car's turn signal system and the trailer light, and the bottom part shows the wiring connections. A checkmark is present at the bottom right.

1. 2. 3. 4. 5. 6.

E bk-ye
 J gn-wh
 K bk-gn
 D ye-wh

L R

D E 1 J K 1

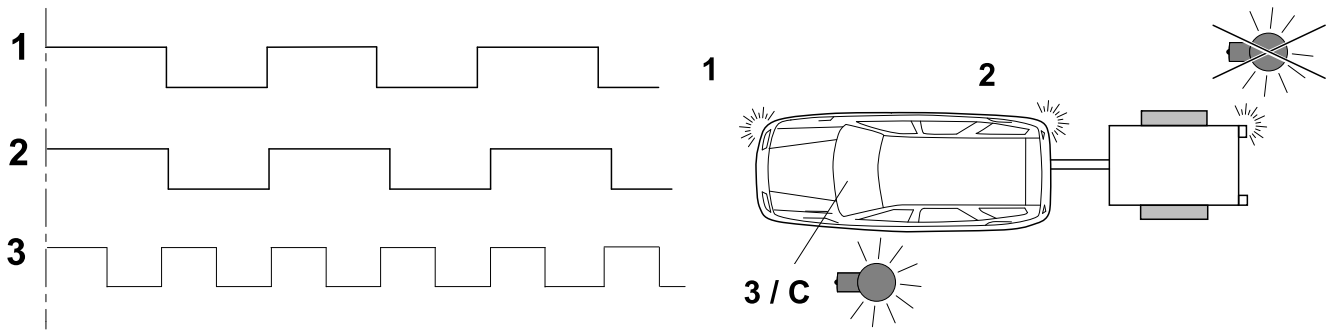

D A GB



- BUL CH CZ DK E EST F FIN
- H HR I LT LV N NL GR
- RO RU S SK SLO TR P PL

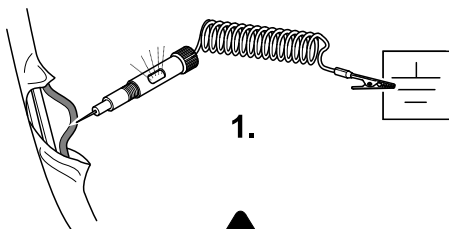
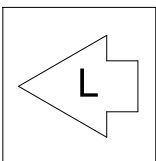
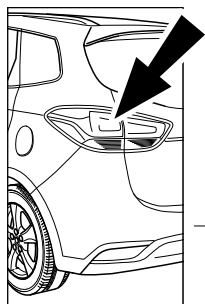

1.

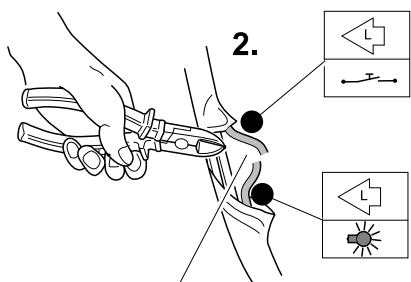
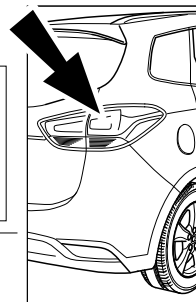
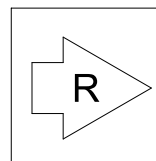

2.

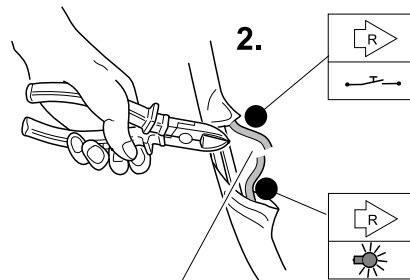

2.

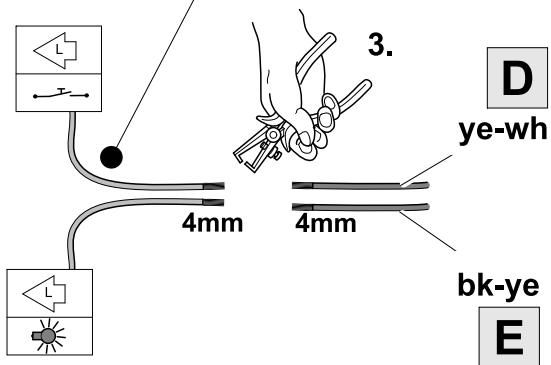

3.

D

ye-wh

bk-ye

E

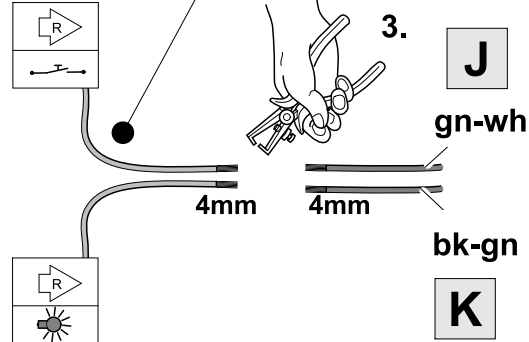

3.

J

gn-wh

bk-gn

K

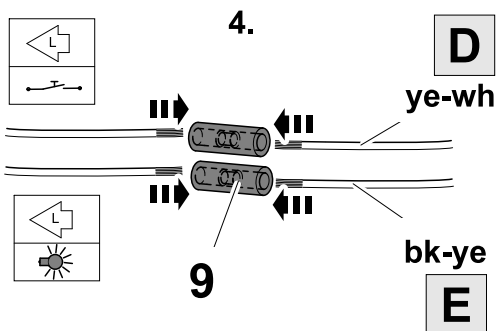

4.

D

ye-wh

bk-ye

E

9

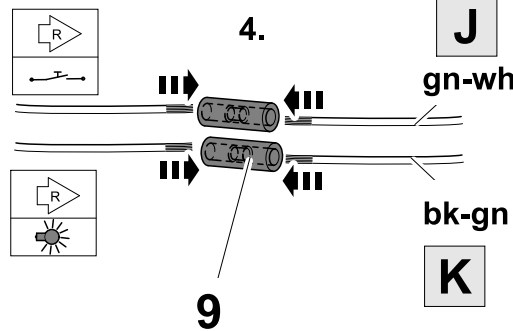

4.

J

gn-wh

bk-gn

K

9

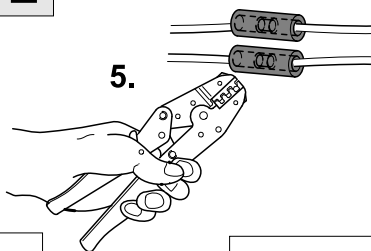

5.

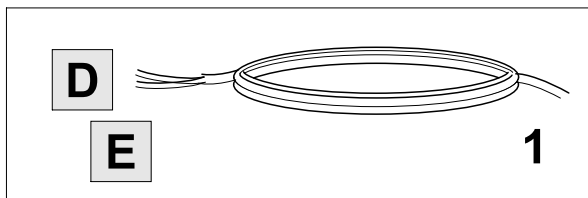

D

E

1

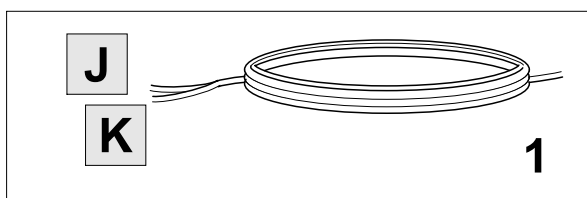

J

K

1

12

WITHOUT MULTIPLEX - SYSTEM / PWM

OPTION 2A

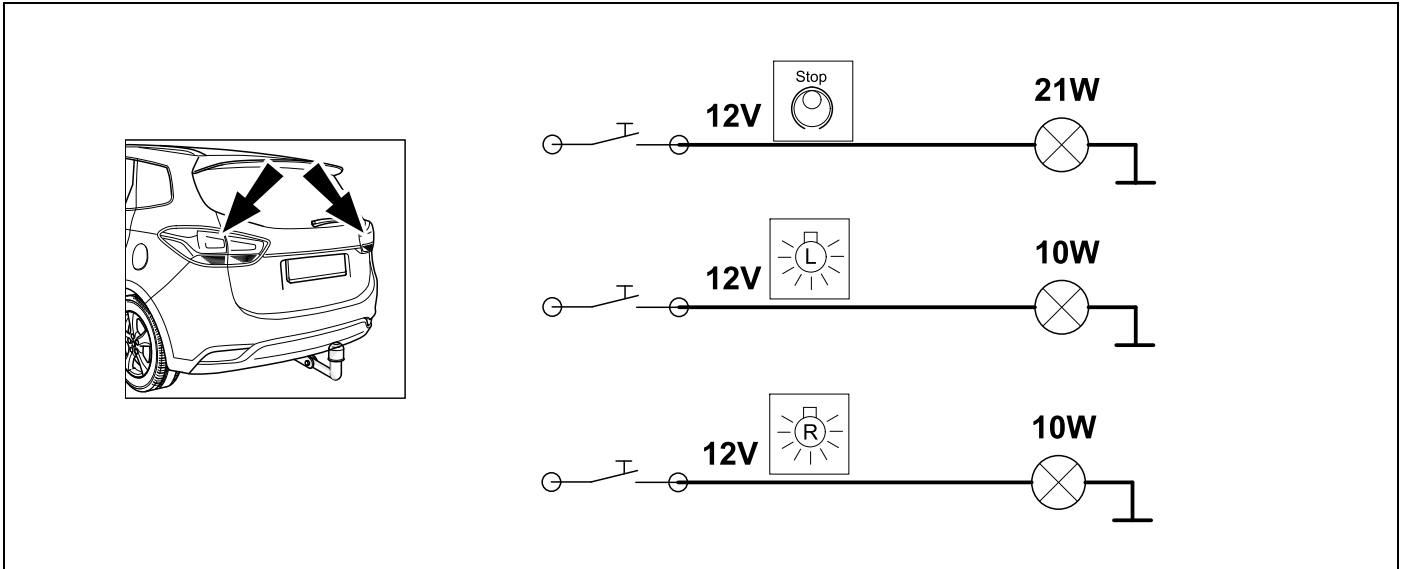

13



5

OPTION 2A

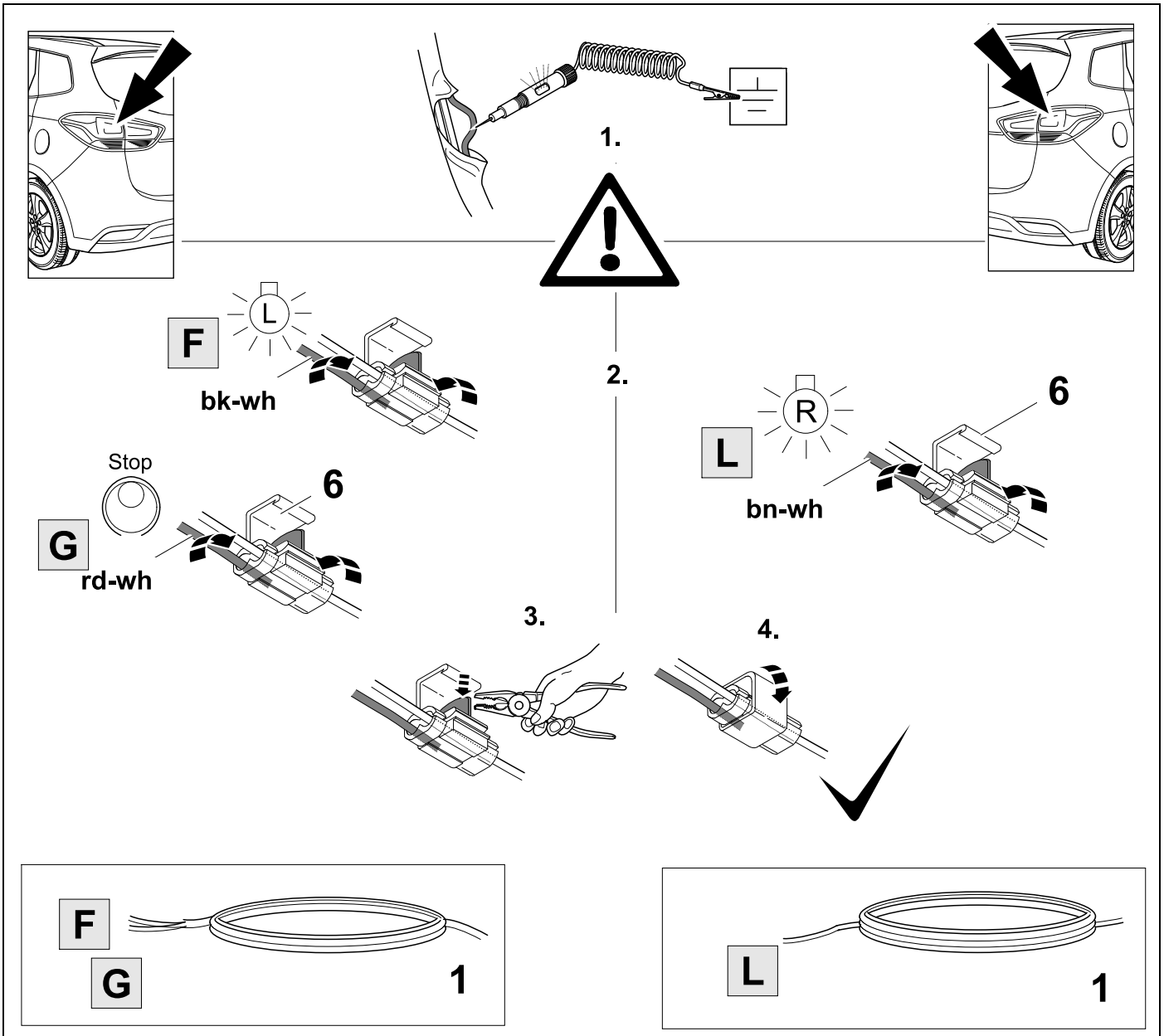

14

WITH MULTIPLEX - SYSTEM / PWM

OPTION 2B

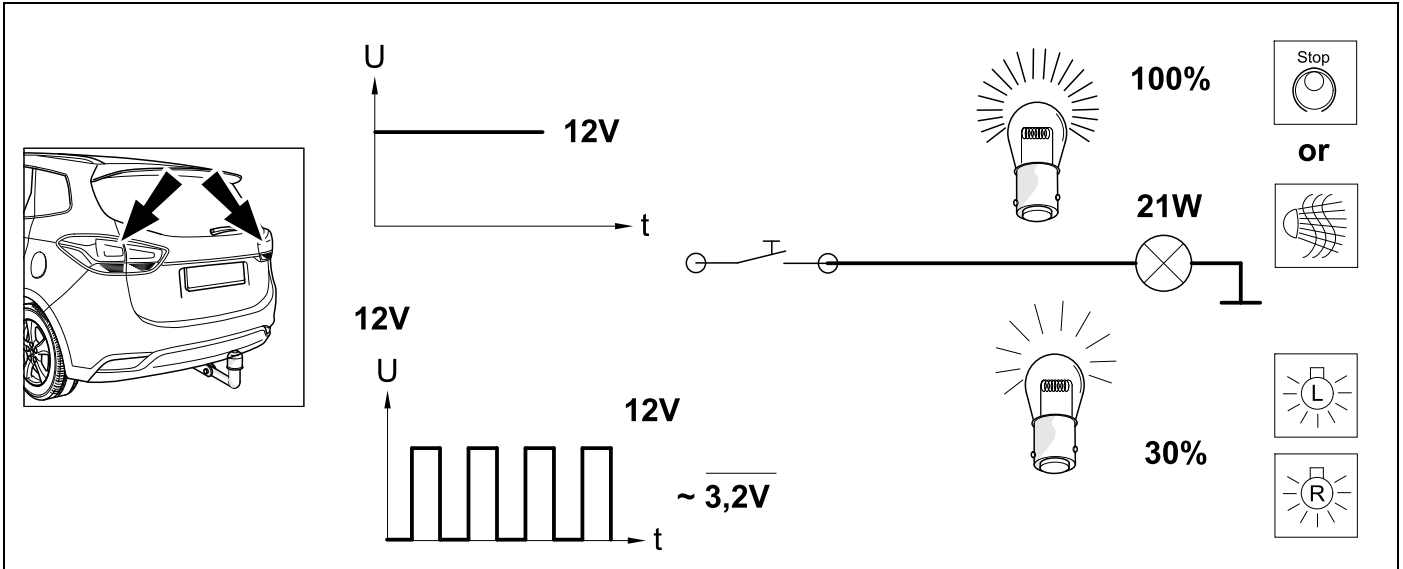

15



5

OPTION 2B

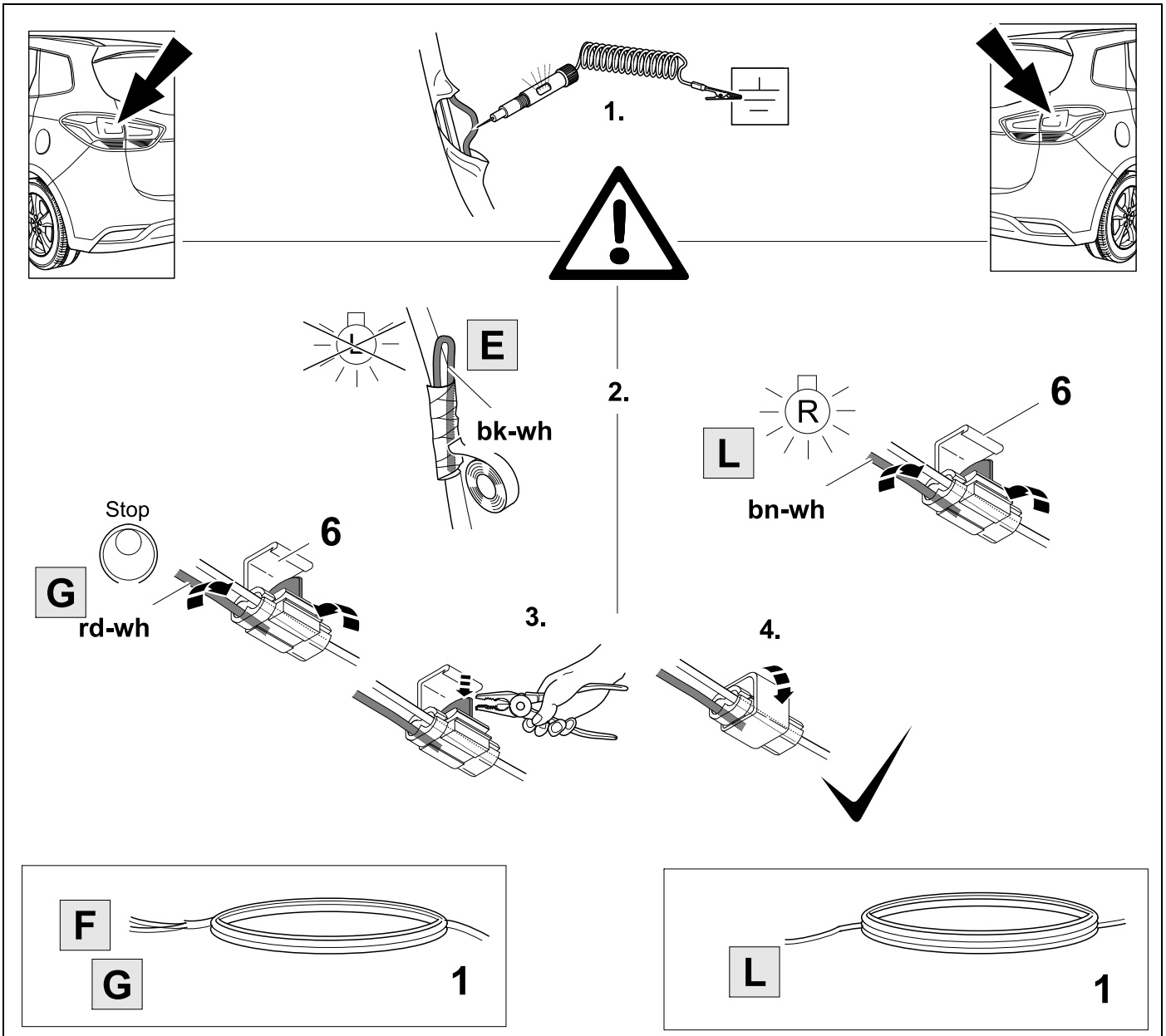

16 POLARITY FOG LAMP (POSITIVE OR NEGATIV SWITCHED)

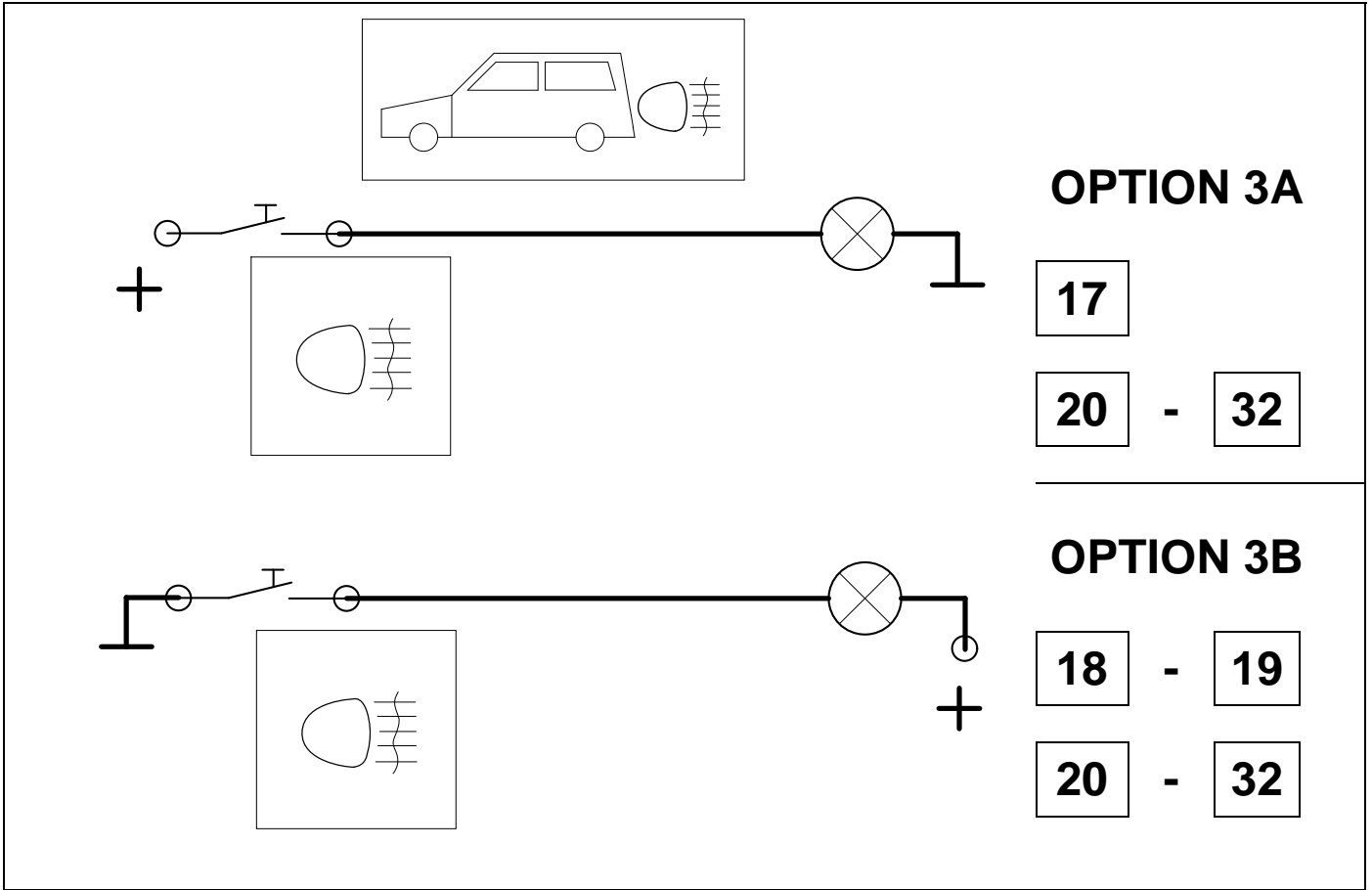

17 POSITIVE SWITCHED



5

OPTION 3A

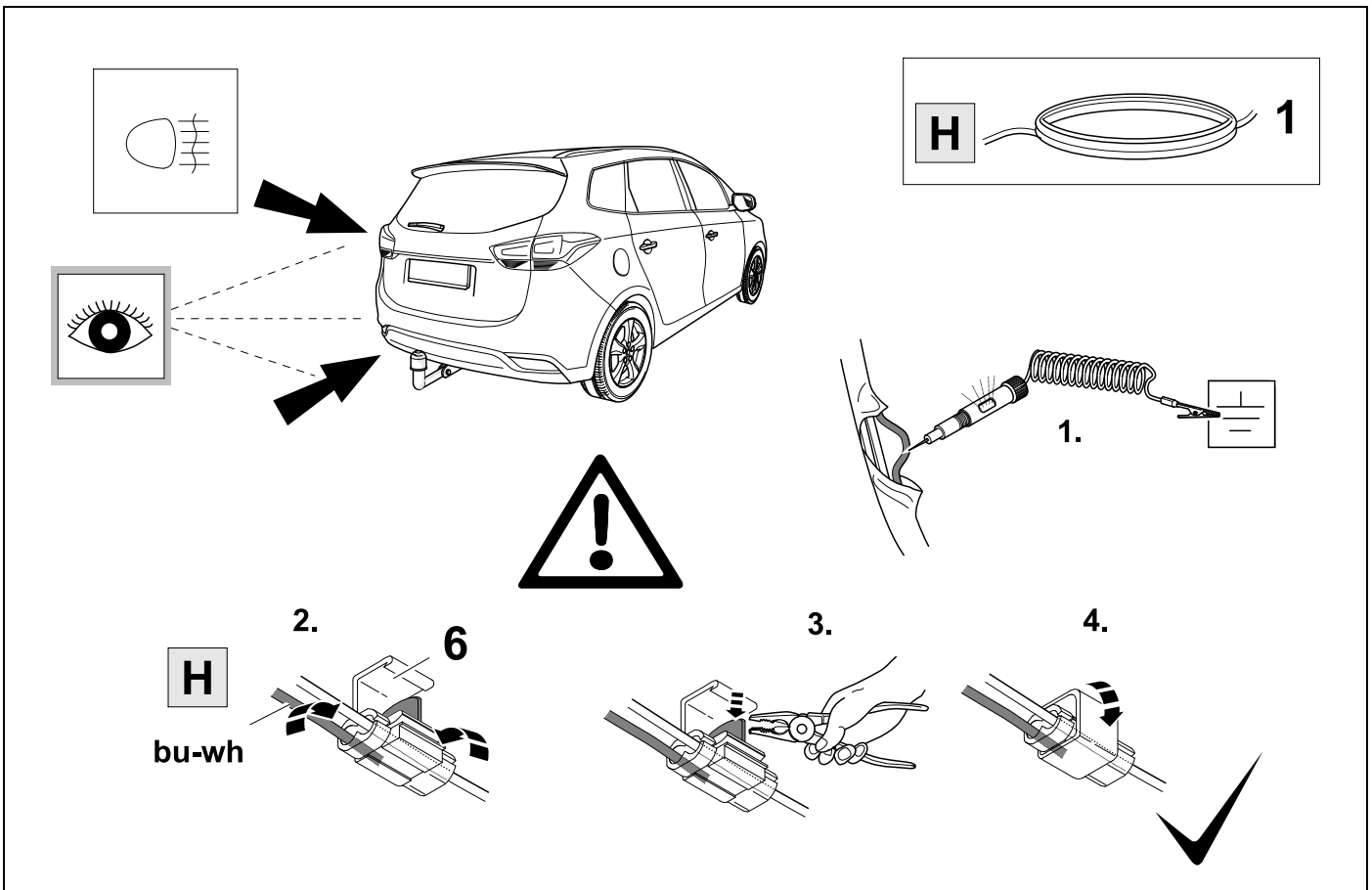

18

NEGATIVE SWITCHED



5

OPTION 3B

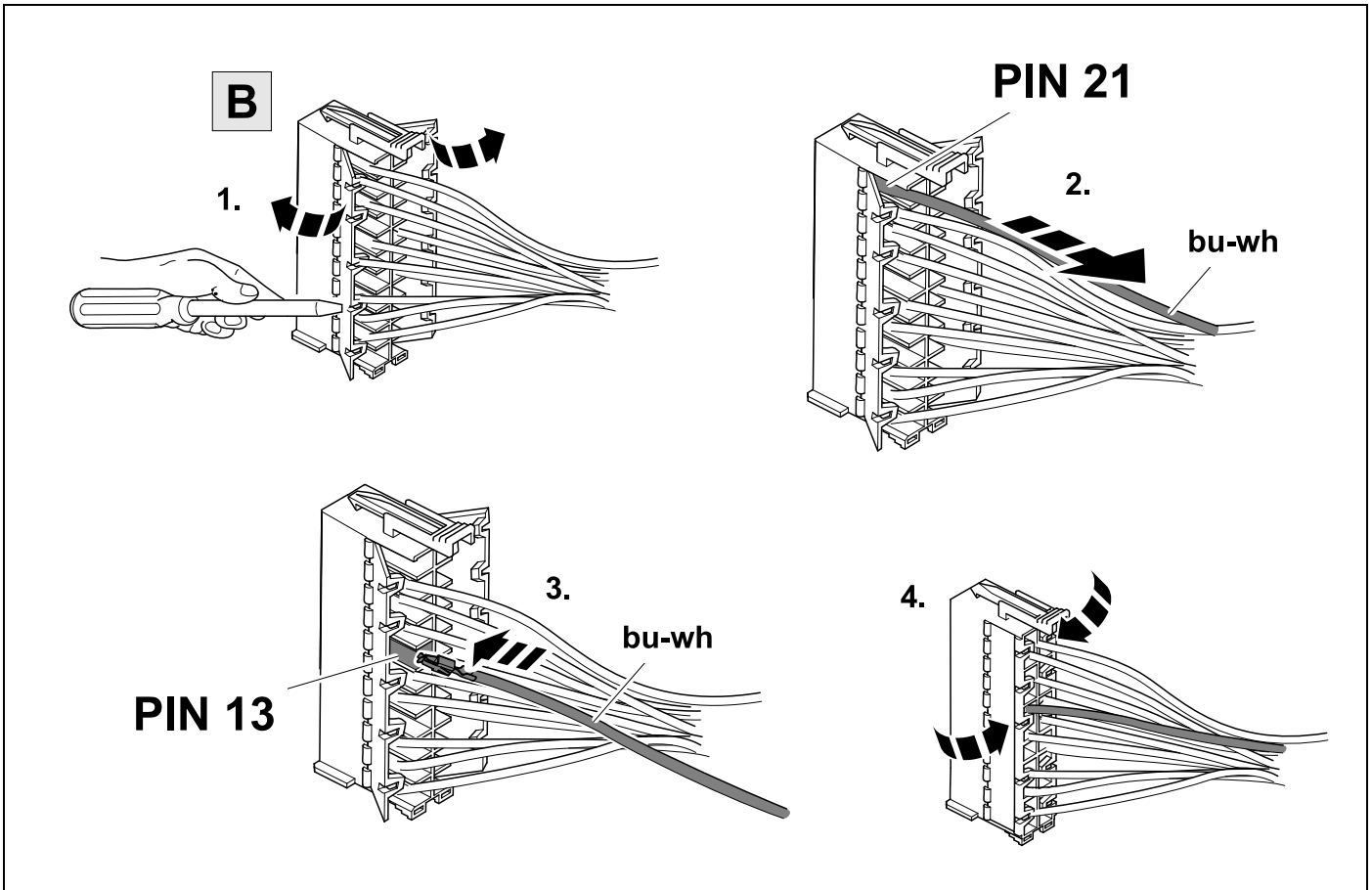

19

NEGATIVE SWITCHED



5

OPTION 3B

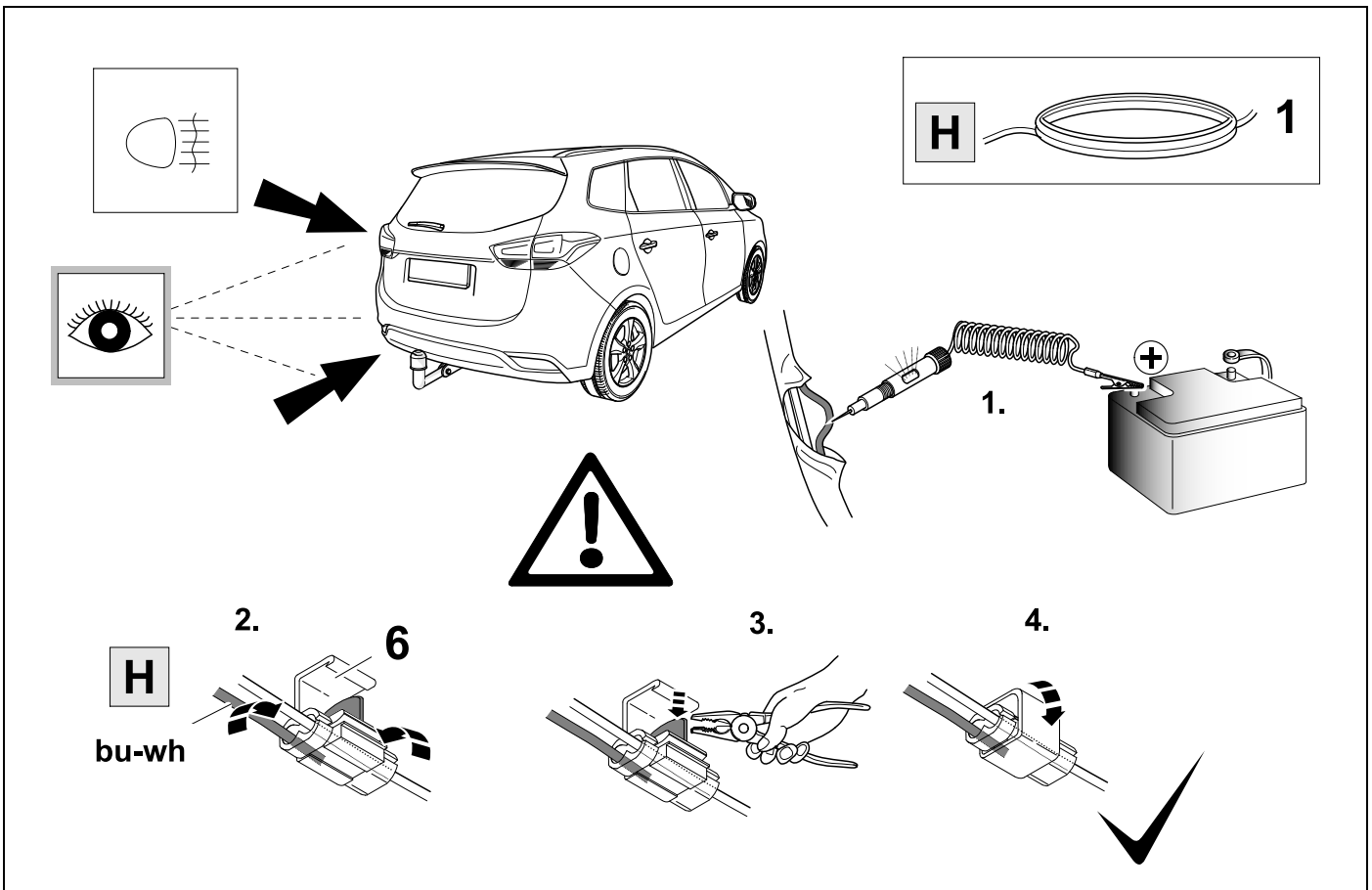

20



5

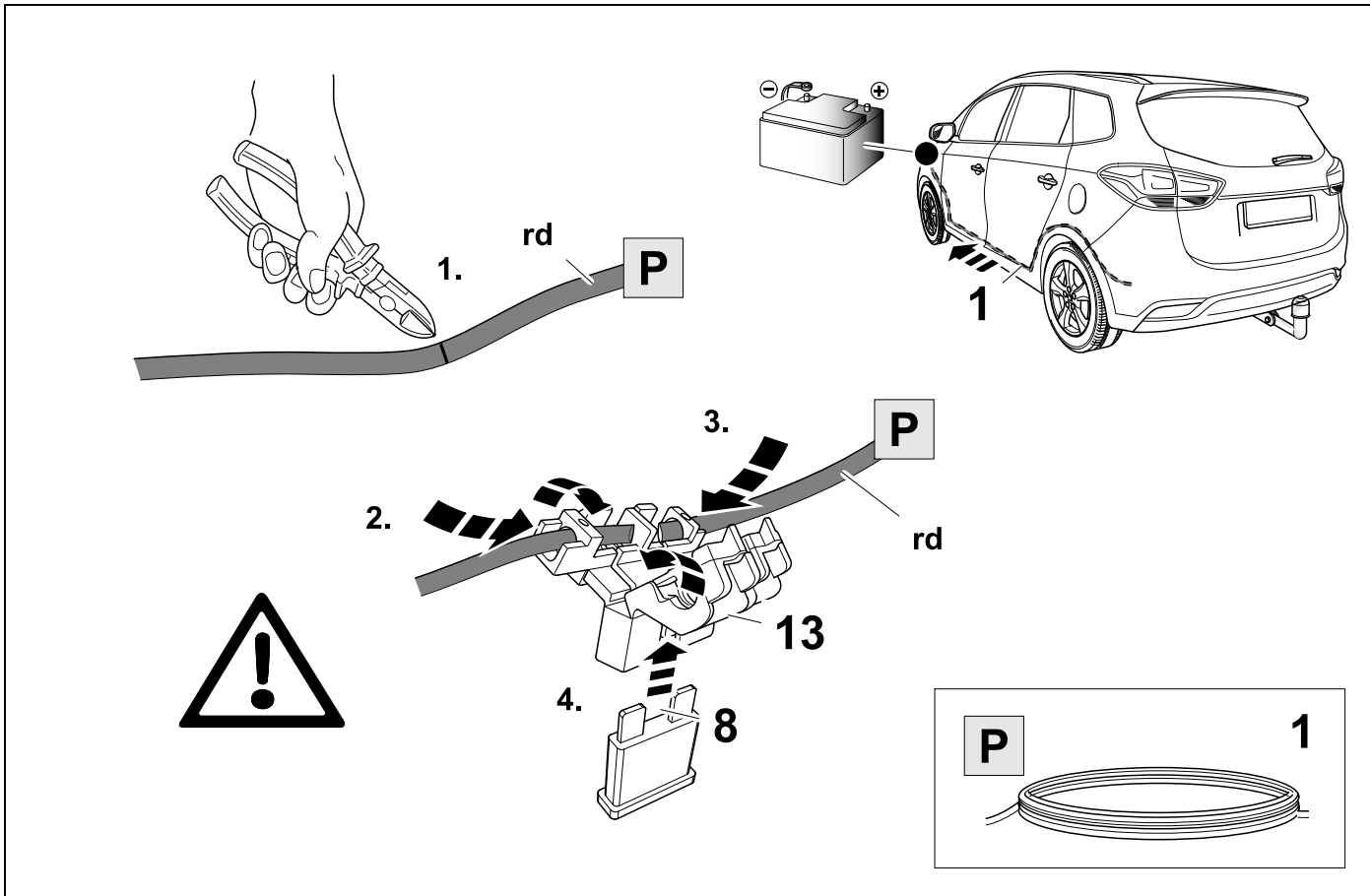

21

OPTION 4A



5

OPTION 4B

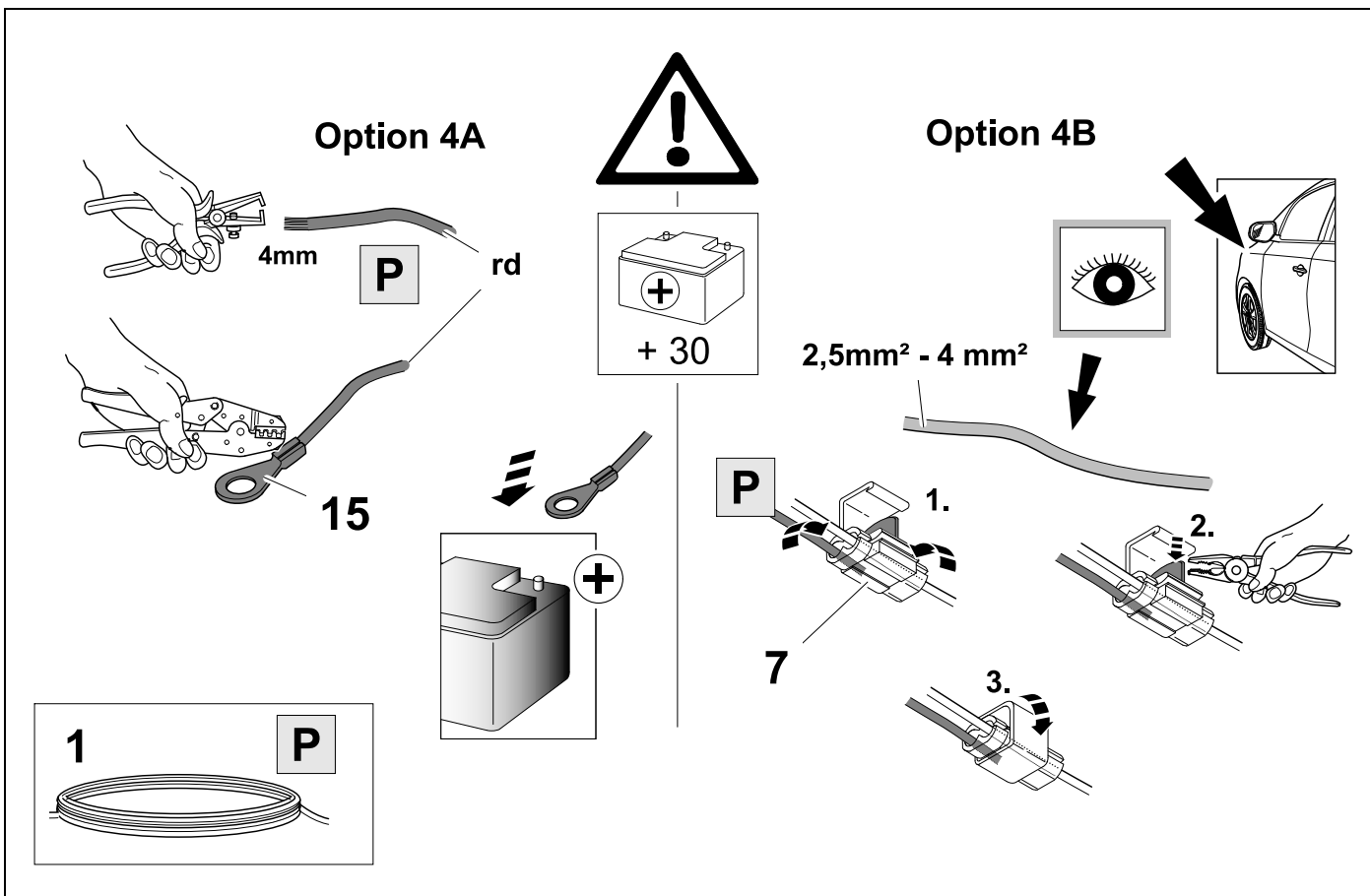

22 PARK DISTANCE CONTROL DEACTIVATION

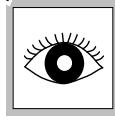
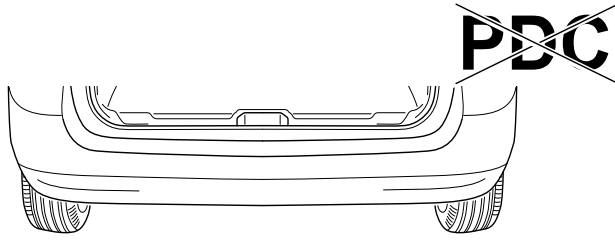

25

-

32

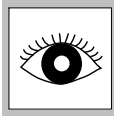
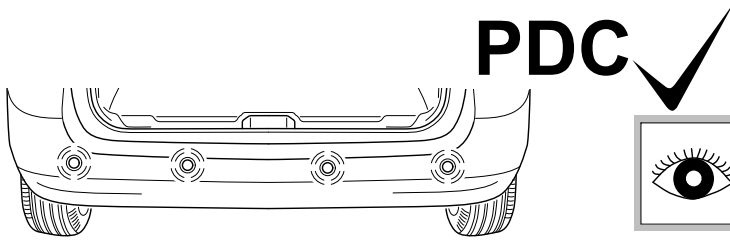

OPTION 5A

23

25

-

32

OPTION 5B

24

25

-

32

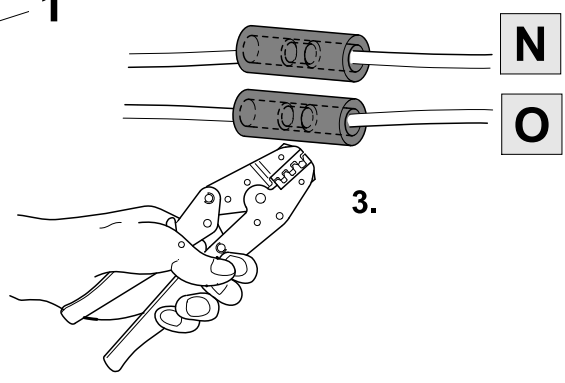
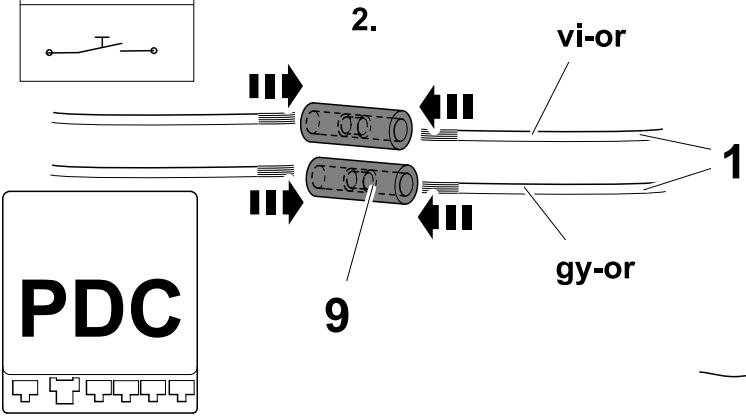
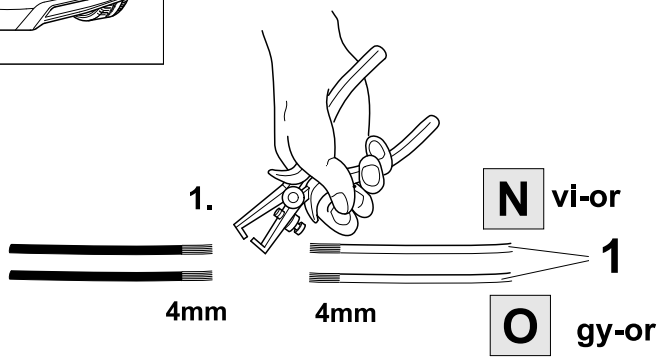
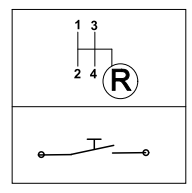
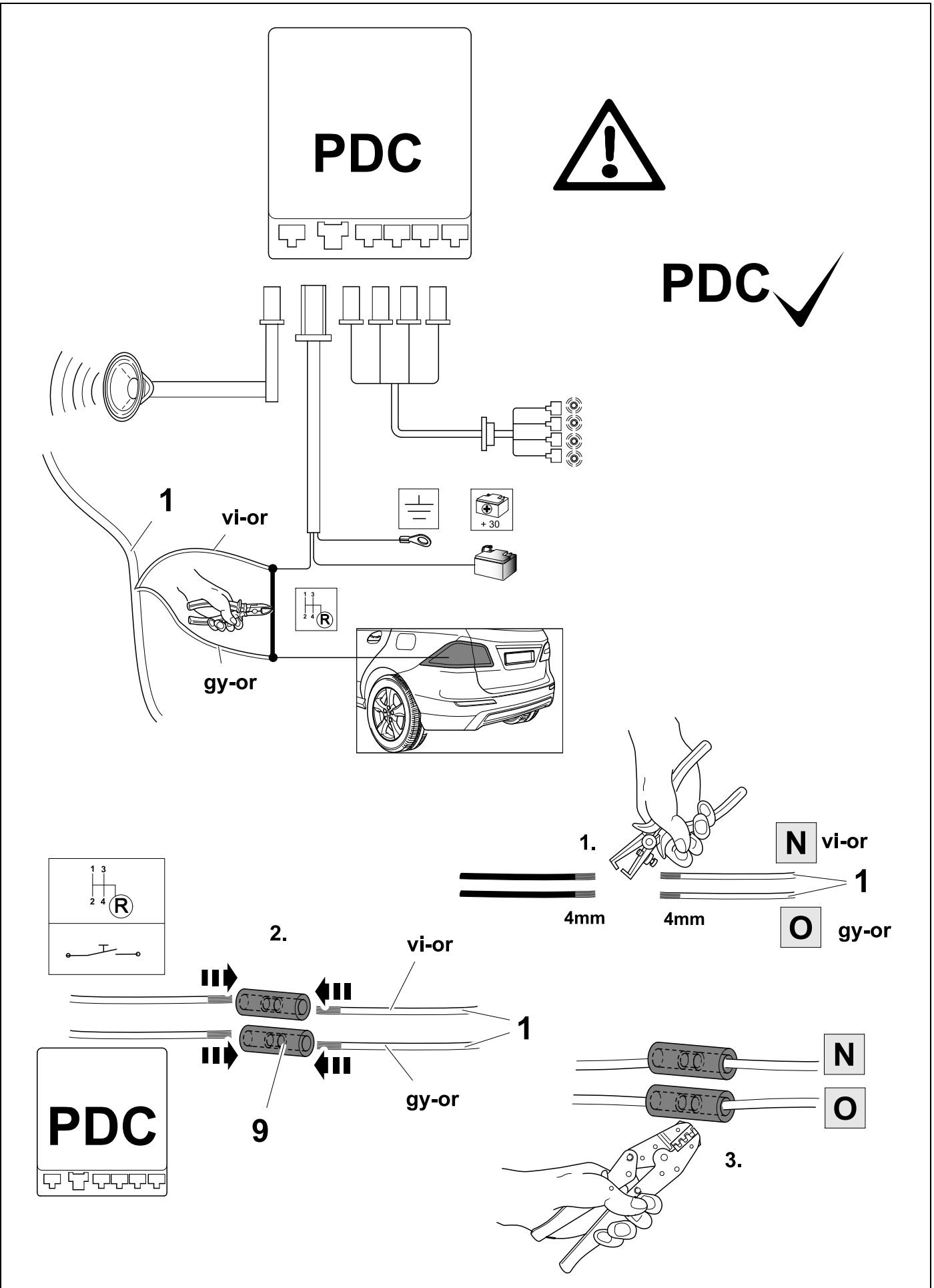

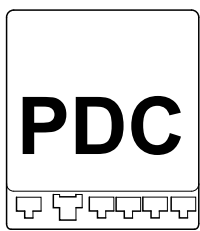
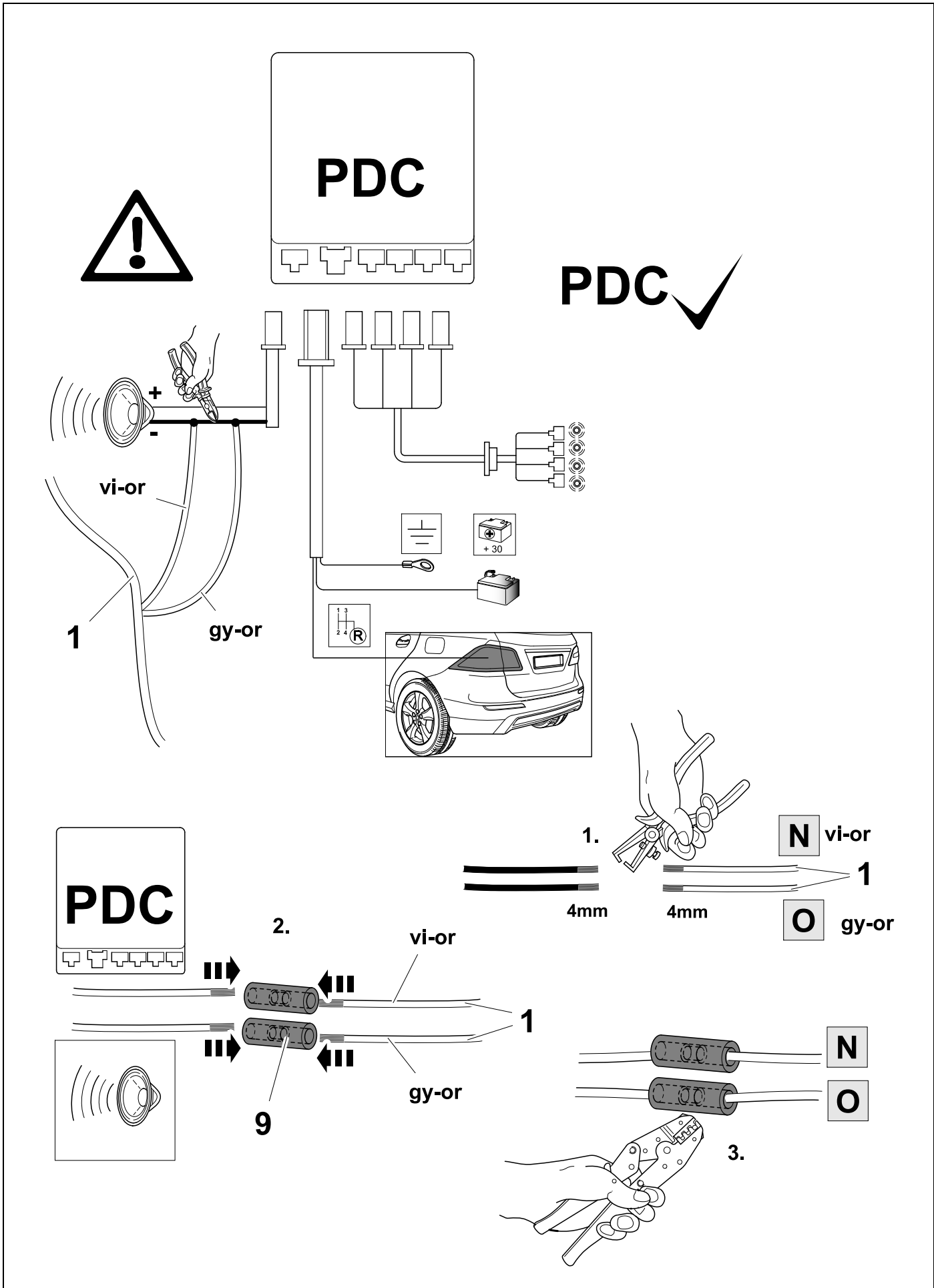

1.

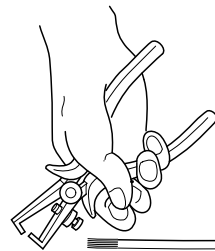
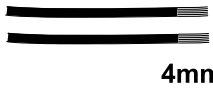

N vi-or

1

O gy-or

2.

vi-or

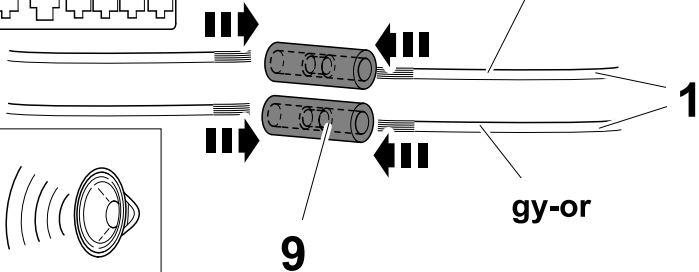

9

gy-or

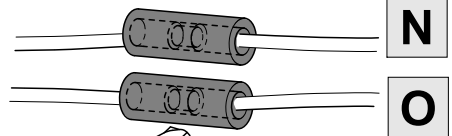

3.

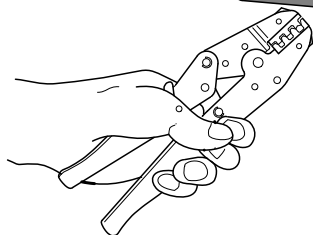

25

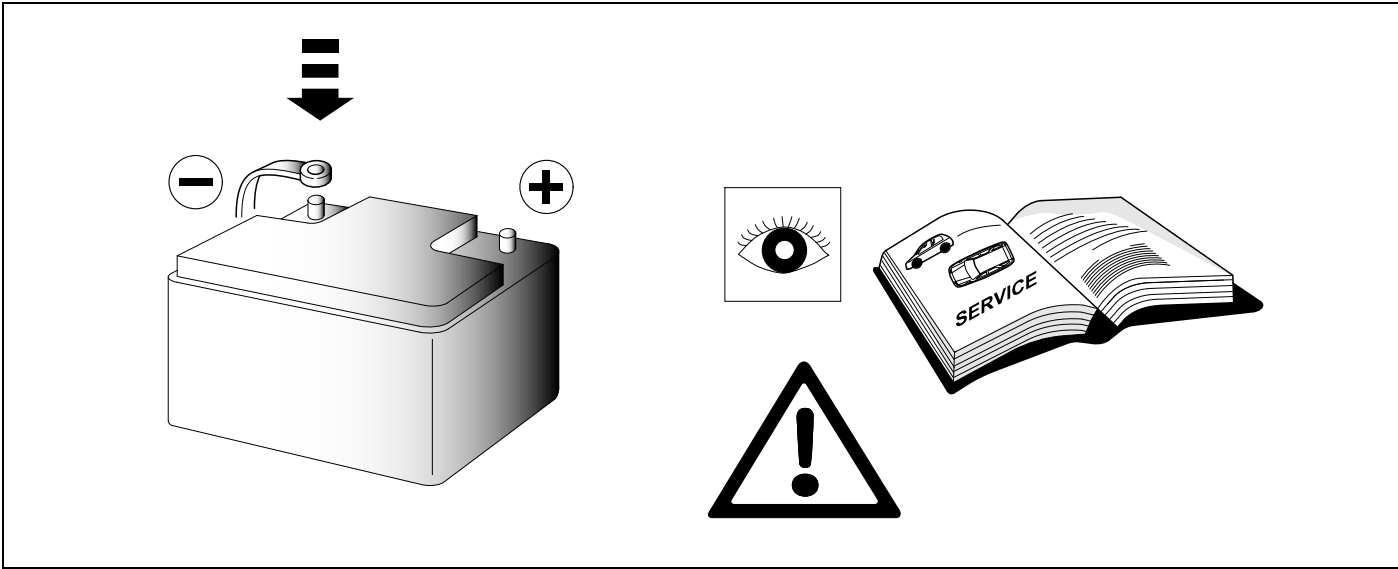

26

CHECK

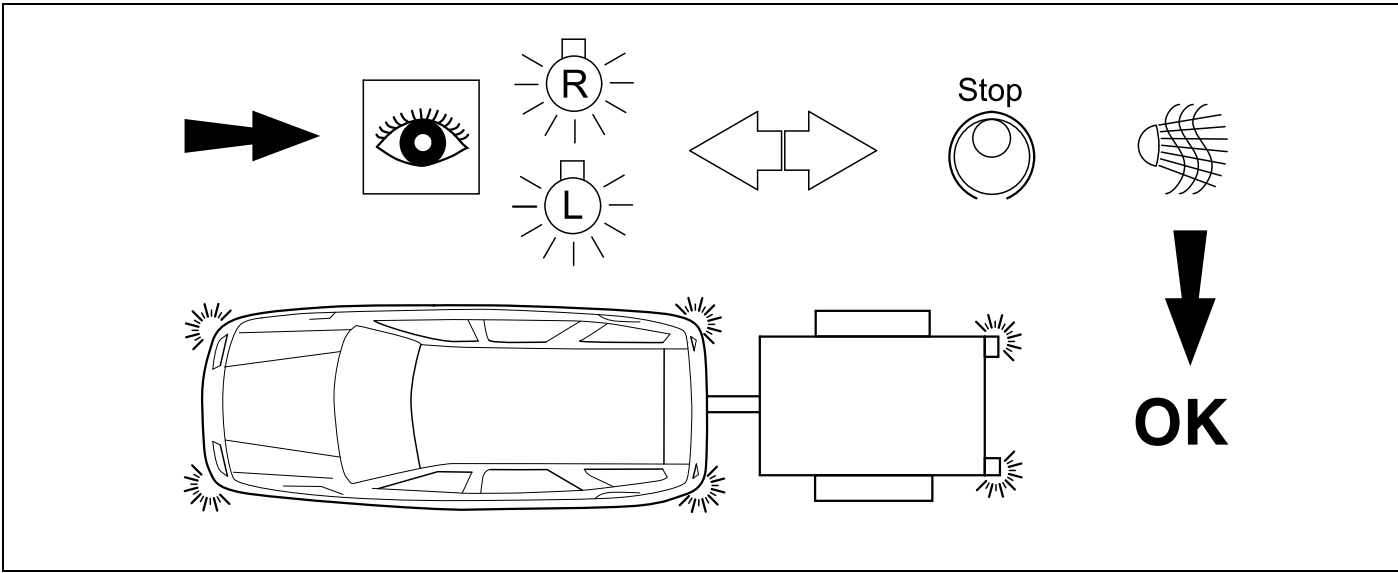

27 CHECK

 ⇒ **10**

FLASHER CONTROL

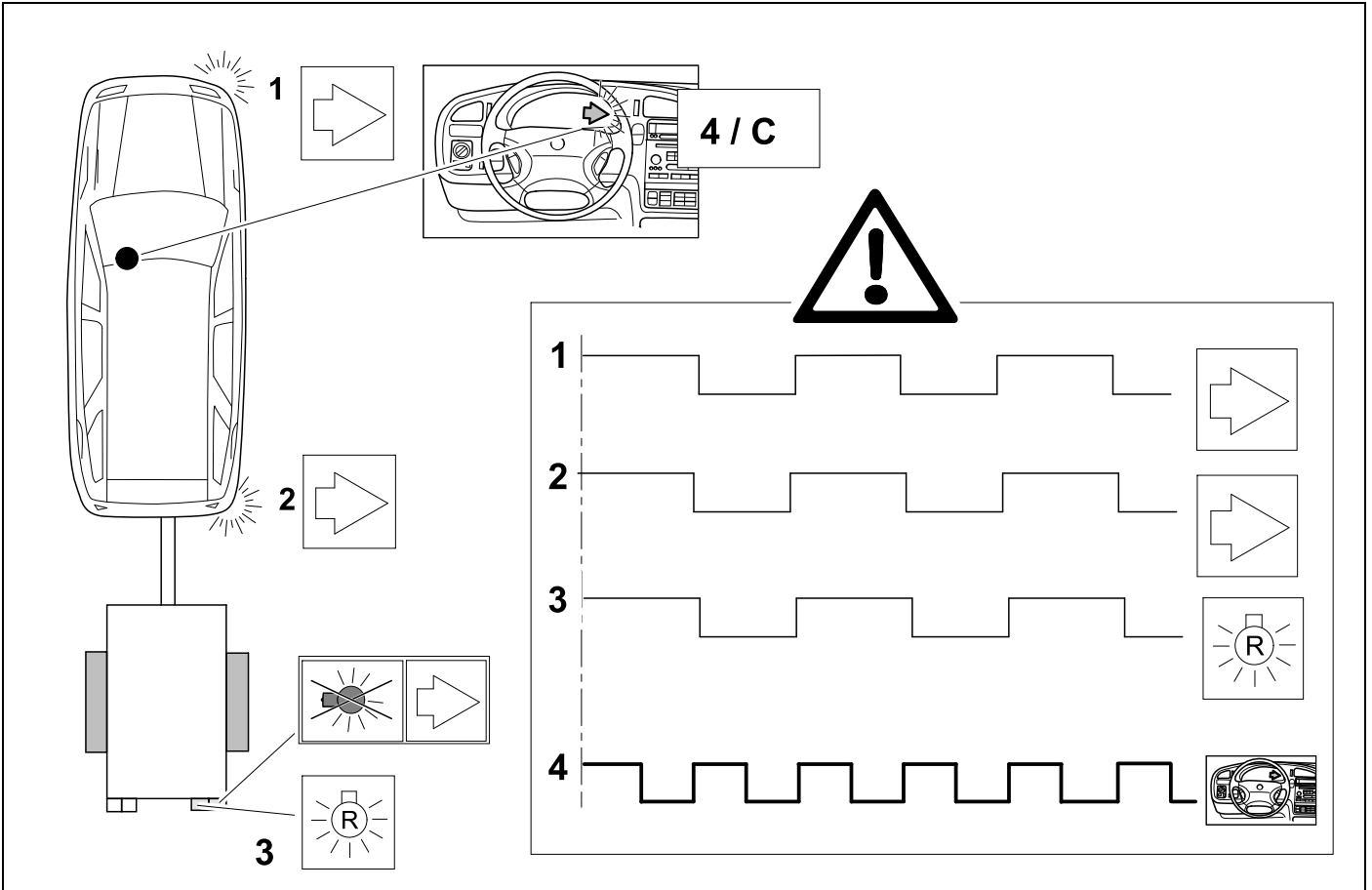

28 INFORMATION

 ⇒ **20**

FUSE

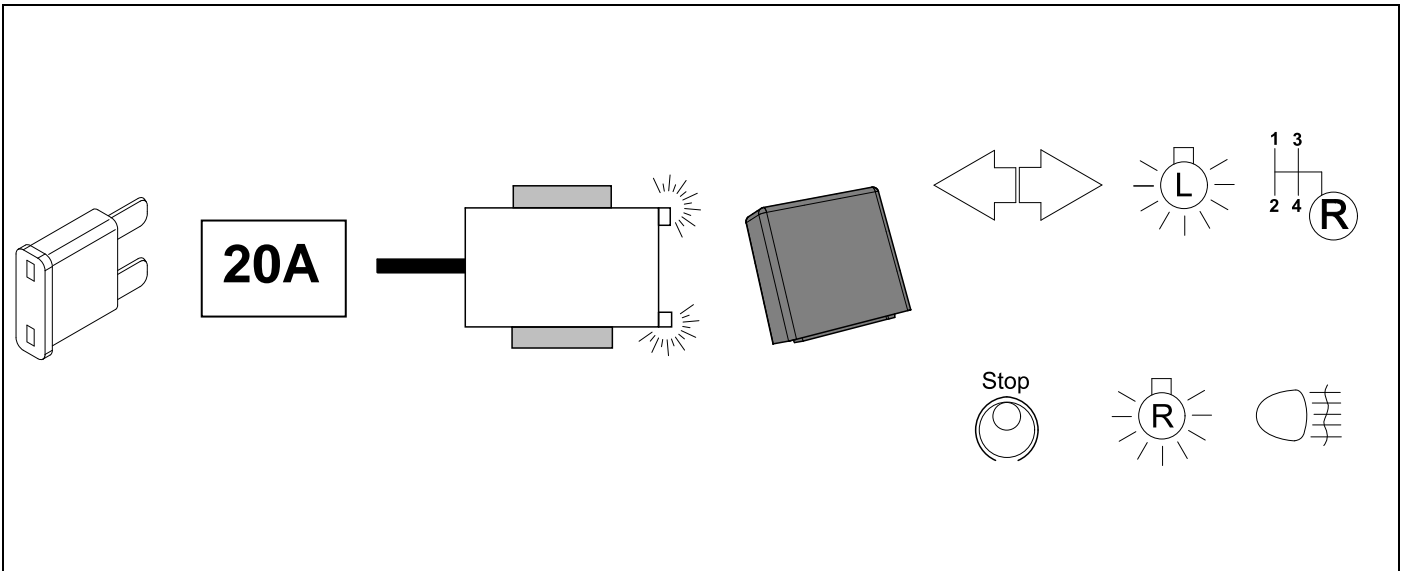



~~D A GB~~



BUL CH CZ DK E EST F FIN
 H HR I LT LV N NL GR
 RO RU S SK SLO TR P PL



D A GB

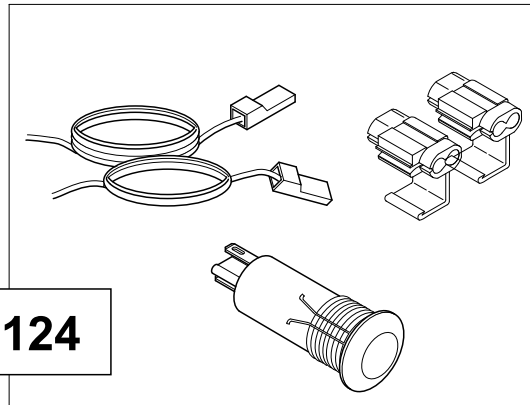
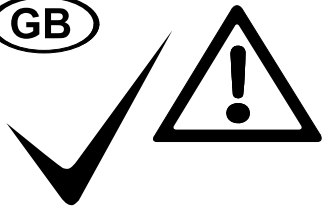

Use Extension Kit 721124

 **ON**

1.

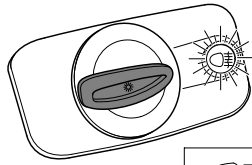

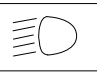
 **ON**

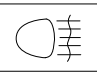
 **ON**

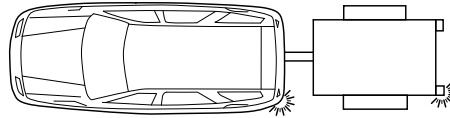

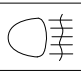
 **ON**

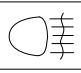
 **ON**

2.

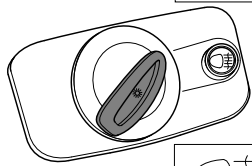

 **ON**

 **OFF**

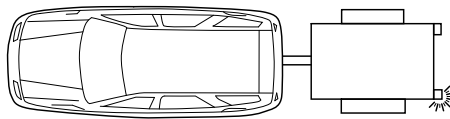

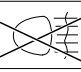
~~~~

 **ON**

 **OFF**

1.

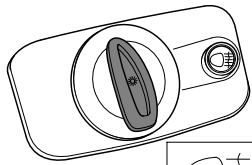

 **OFF**

 **OFF**

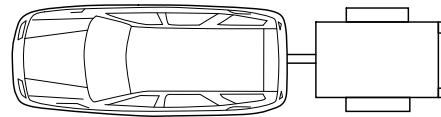

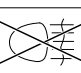
~~~~

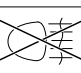
~~~~

OPTION 1

 **OFF**

1.

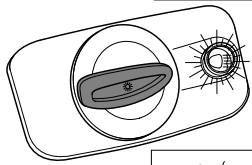

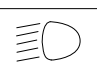
 **ON**

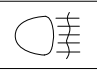
 **ON**

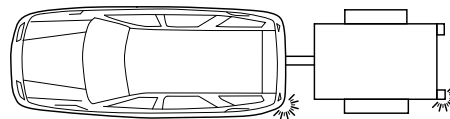

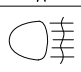
 **ON**

 **ON**

OPTION 2

2.

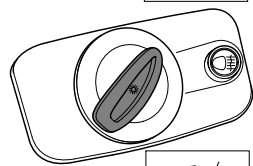

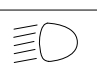
 **ON**

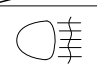
 **OFF**

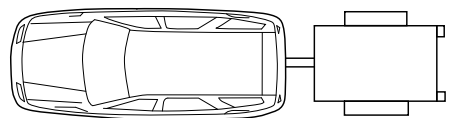

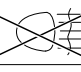
~~~~

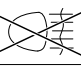
~~~~

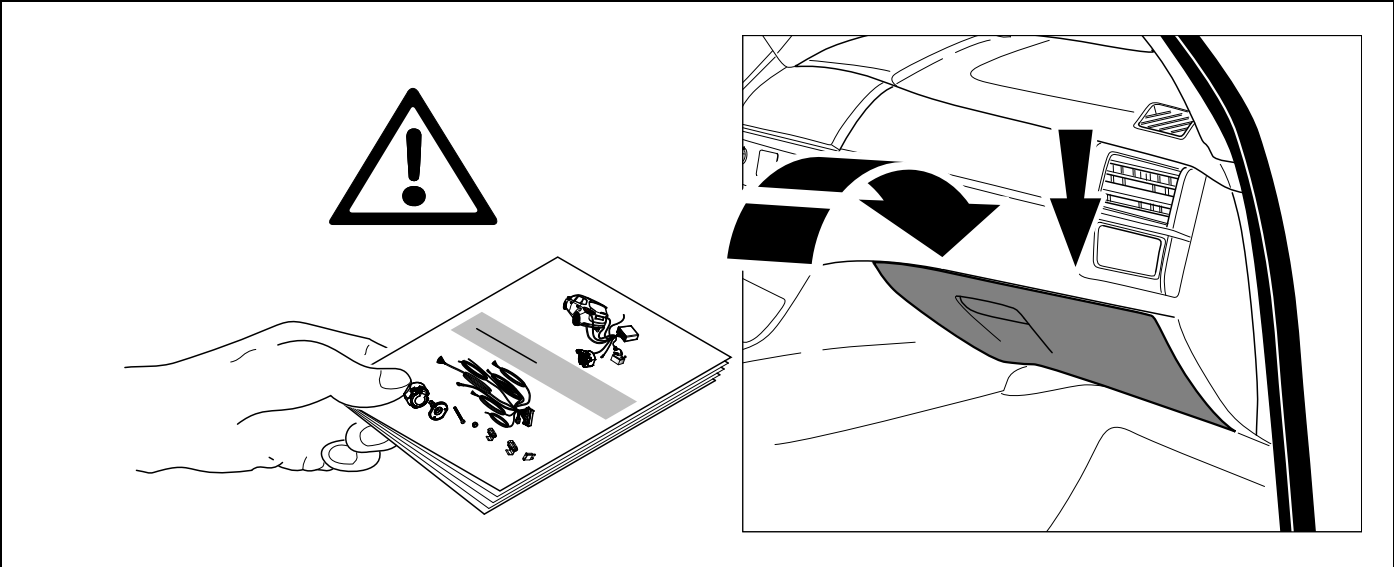

EXPERT SCHEMATIC WITHOUT TRAILER FLASHER CONTROL

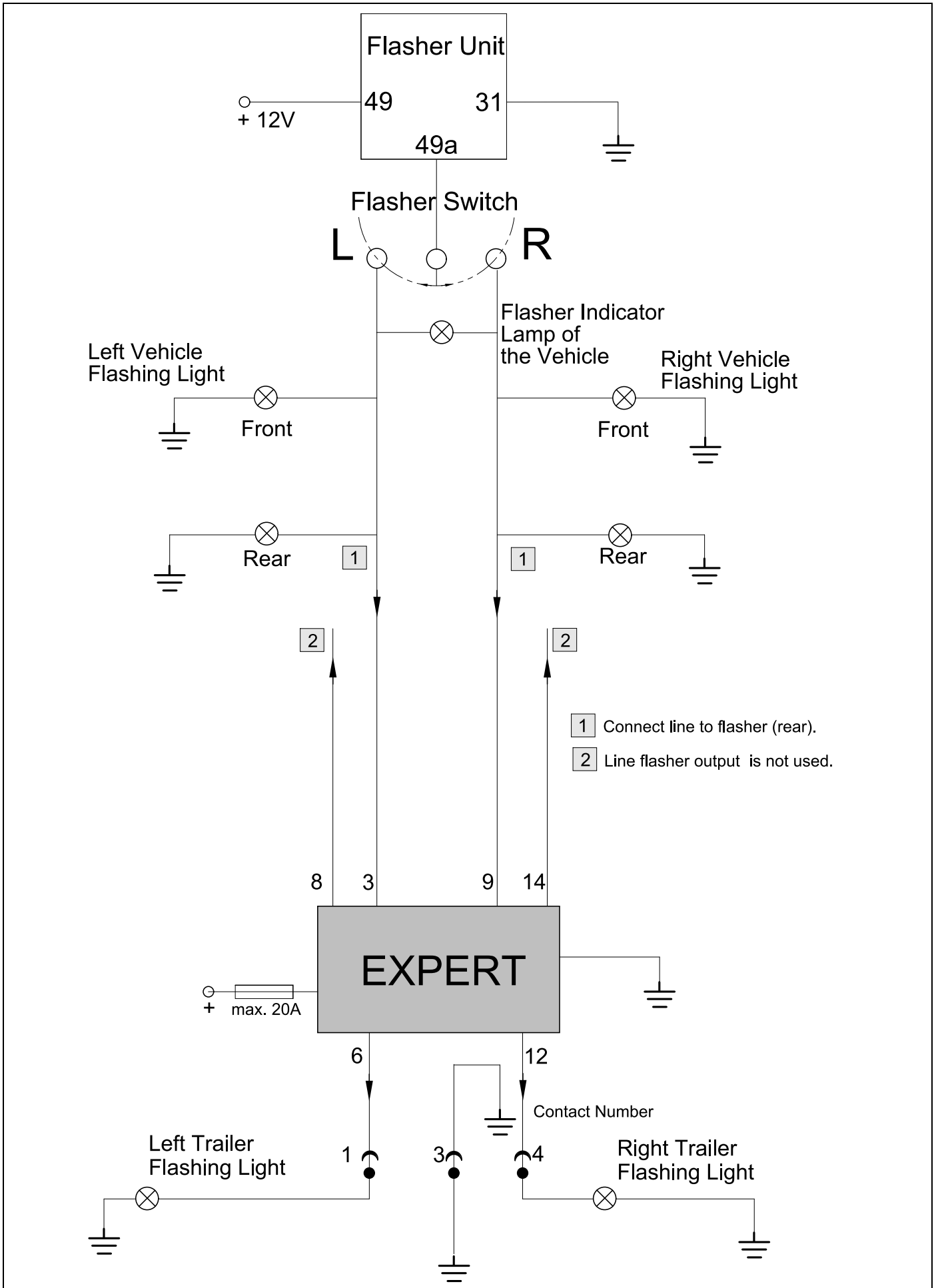

EXPERT SCHEMATIC WITH TRAILER FLASHER CONTROL

